

Front Terminal, Valve Regulated Lead Acid Batteries, AGM Technology

SPECIFICATION		
Nominal voltage		12V
Nominal capacity		230Ah _{C10}
Design life		12 years @ 20°C
Dimensions	Length	522mm
	Height	224mm
	Width	238mm
Weight		73,2kg
Internal resistance		2,5mΩ
Capacity @ 25°C	10h	230Ah
	5h	196Ah
	1h	138Ah
	1C	86Ah
Operating temperature ranges	Charge	-15°C ÷ 40°C
	Discharge	-15°C ÷ 50°C
	Storage	-15°C ÷ +40°C
Charging voltage @ 20°C	Standby	13,5V ÷ 13,8V
	Cyclic	14,4V ÷ 15V
Charge current		<69A
Maximum discharge current for 5 sec.		1840A
Connection terminal		F18
Container material		ABS UL94 HB

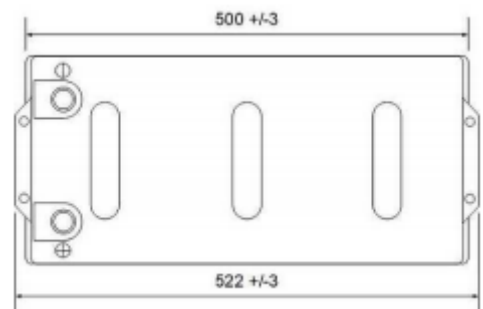
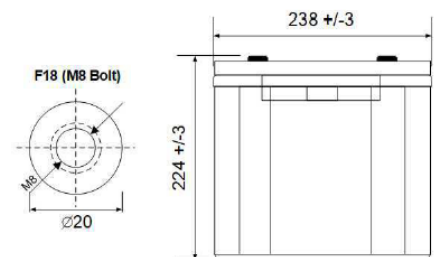
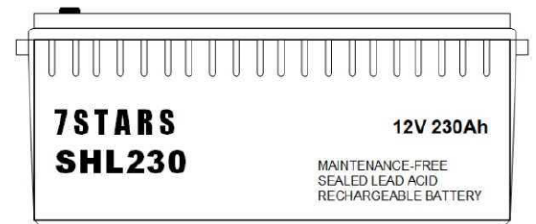

Constant power discharge table W/block @ 25°C

V/block	5 min	10 min	15 min	30 min	1 h	1,5 h	2 h	3 h	4 h	5 h	10 h	20 h
11,1V	6566	5059	4152	2674	1497	1116	966	708	553	474	257	139
10,8V	7223	5518	4488	2856	1604	1212	1020	750	582	496	269	146
10,5V	7798	5934	4813	3051	1702	1272	1062	774	600	508	278	150
10,2V	8208	6246	5064	3222	1782	1320	1092	792	618	520	185	153
10V	8405	6390	5179	3298	1818	1344	1104	798	64	523	287	154
9,9V	8561	6508	5294	3374	1853	1368	1116	804	630	527	290	155
9,6V	8906	6773	5498	3475	1889	1398	1140	816	636	533	294	157